

**INTERDECOR**

**EXTERIEUR**

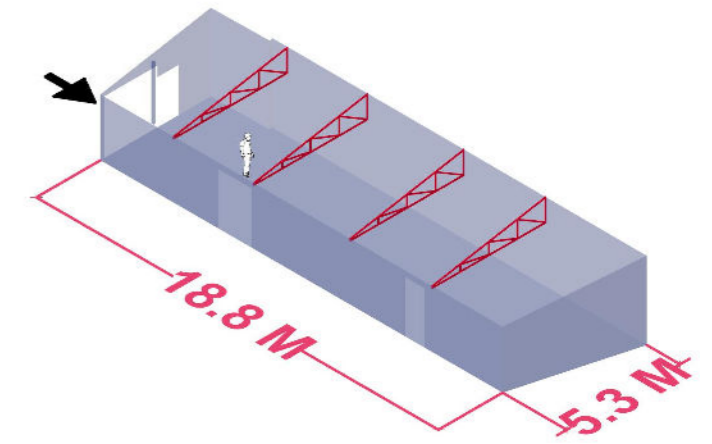

**Caractéristiques**

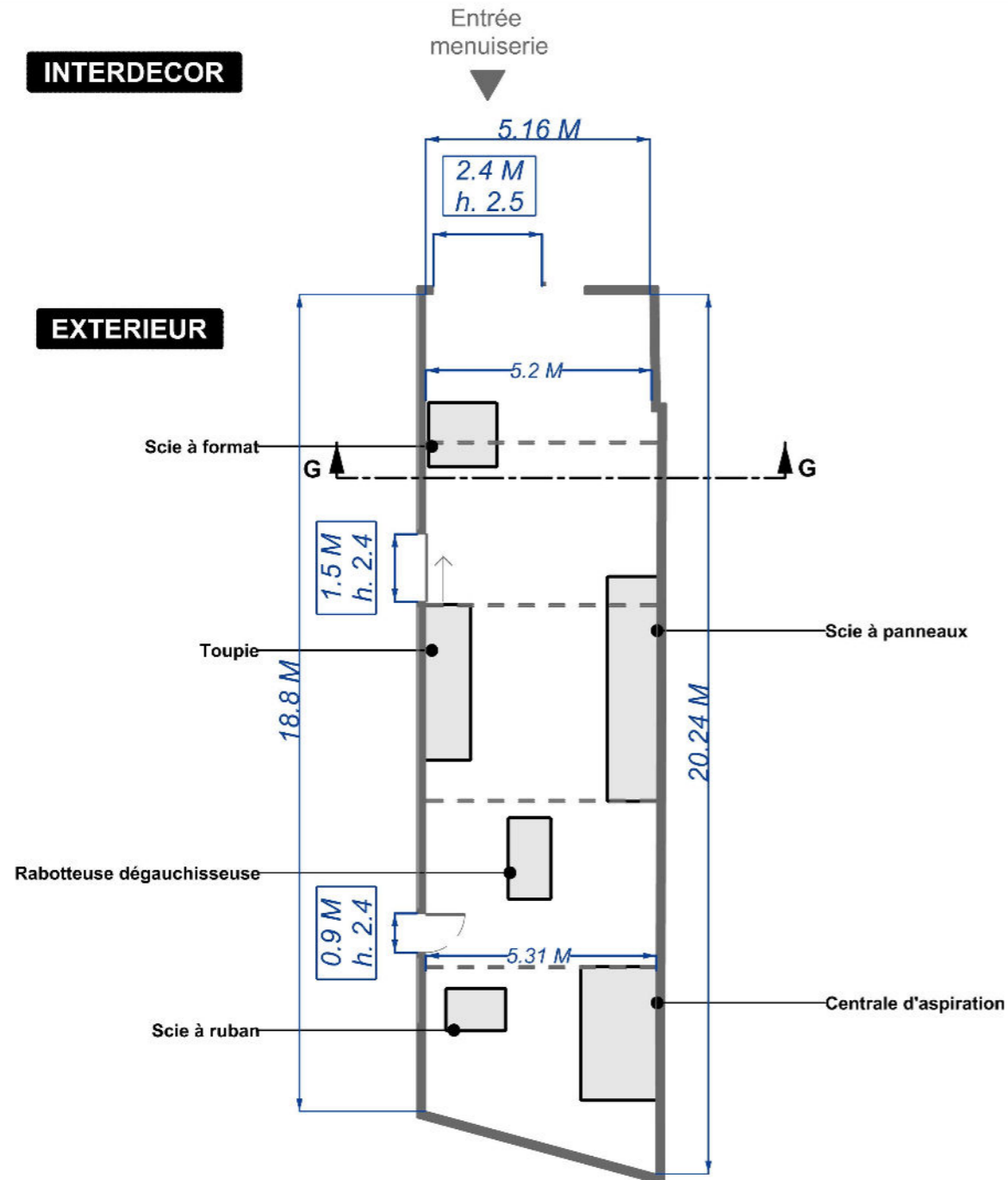

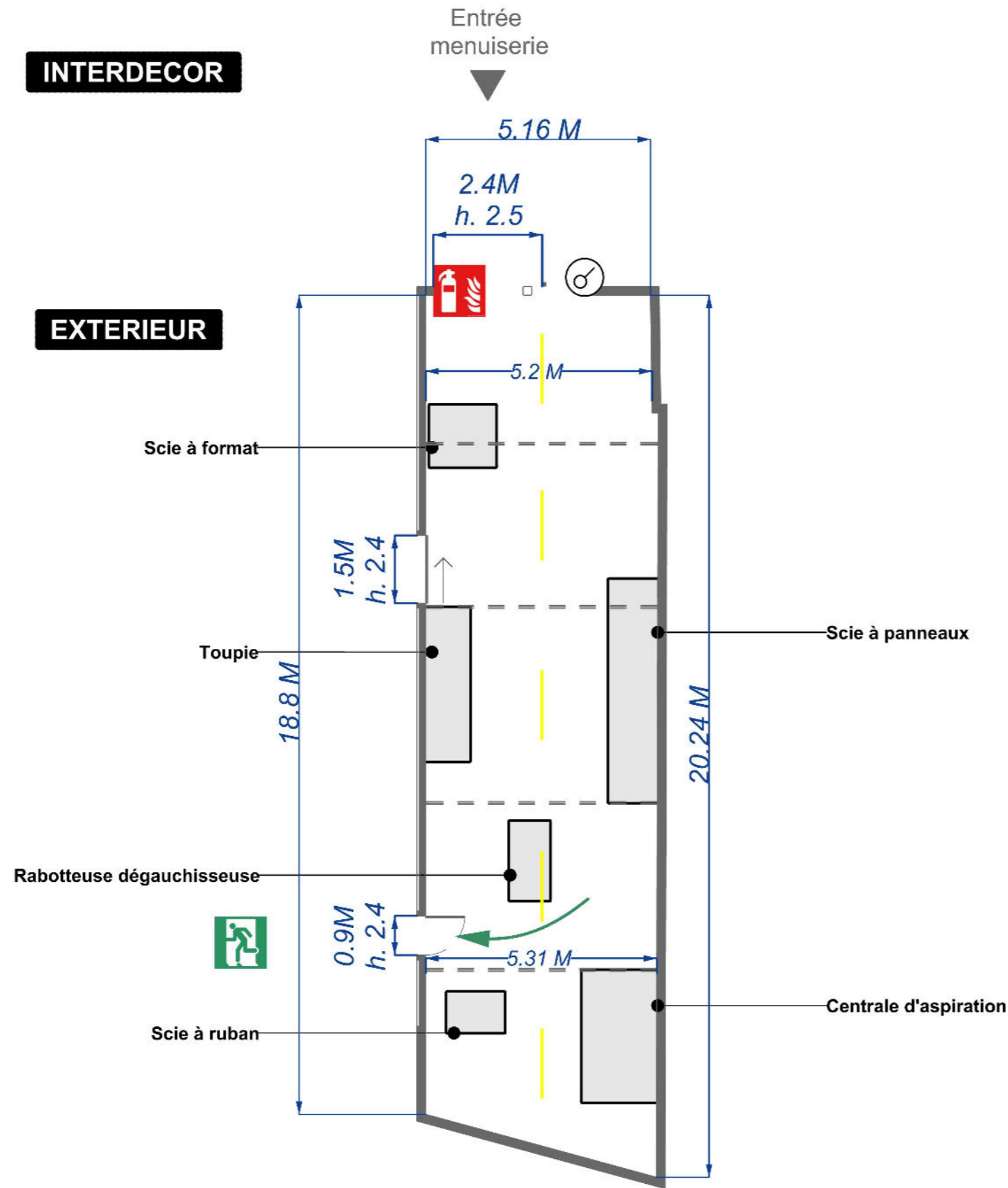

Surface globale : 100m<sup>2</sup>  
Longueur utile : 18.8m  
Largeur utile : 5.2m  
Hauteur sous fermes : 2.5m au plus bas  
Accès menuiserie : 2.4 x 2.5m de haut  
Nature du sol : béton peint

**MENUISERIE 1**

# MENUISERIE 1

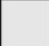

## PLAN INSTALLATIONS MISES A DISPOSITION

-  MACHINE
-  PASSERELLE/ FERME
-  INTERRUPTEUR
-  FLUOS
-  ITINERAIRE D'EVACUATION

Date impression 17/03/2022	Page 2/2
Echelle 1/120	Feuille A3